

CARATTERISTICHE FUNZIONAMENTO - OPERATING DATA - CARACTERISTIQUES DE FONCTIONNEMENT

| POMPA TIPO PUMP TYPE POMPE TYPE | Potenza motore Motor rating Puissance moteur [kW] | Giri/min RPM T/min | Aspirazione Suction Orifice aspiration DNa | Mandata Delivery Refoulement DNm | PORTATA - CAPACITY - DEBIT [m ³ /h] | | | | | | | | | | | | | | | | | | | | | |
|---------------------------------------|--|--------------------------|---|---|--|------|------|------|------|------|------|------|------|------|-----|-----|--|--|--|--|--|--|--|--|--|--|
| | | | | | PORTATA - CAPACITY - DEBIT [l/sec] | | | | | | | | | | | | | | | | | | | | | |
| | | | | | 0 | 36 | 54 | 72 | 90 | 108 | 144 | 180 | 216 | 252 | 288 | 324 | | | | | | | | | | |
| | | | | | PREVALENZA - HEAD - HAUTEUR [m] | | | | | | | | | | | | | | | | | | | | | |
| ETV 15 - 80 | 15 | 2900 | 100 | 80 | 40 | 37.3 | 36.1 | 34.7 | 32.7 | 30.7 | 25.2 | | | | | | | | | | | | | | | |
| ETV 18.5 - 80 | 18.5 | | | | 45.4 | 43 | 41.5 | 40.2 | 38.4 | 36.2 | 30.8 | | | | | | | | | | | | | | | |
| ETV 22 - 80 | 22 | | | | 51.1 | 48.6 | 47.2 | 45.6 | 43.7 | 41.5 | 36.3 | 29.5 | | | | | | | | | | | | | | |
| ETV 2.2 - 80 | 2.2 | | | | 10.5 | 9.2 | 8.1 | 6.8 | 5.1 | | | | | | | | | | | | | | | | | |
| ETV 3 - 80 | 3 | | | | 12.8 | 11.3 | 10.4 | 9.1 | 7.4 | 5.3 | | | | | | | | | | | | | | | | |
| ETV 4 - 80 | 4 | | | | 15.6 | 14.1 | 13 | 11.7 | 10 | 8 | | | | | | | | | | | | | | | | |
| ETV 4 - 100 | 4 | 1450 | 150 | 100 | 9.8 | 9.5 | 9 | 8.4 | 7.3 | 5.8 | | | | | | | | | | | | | | | | |
| ETV 5.5 - 100 | 5.5 | | | | 12 | 11.6 | 11.2 | 10.6 | 9.7 | 8.3 | 3.7 | | | | | | | | | | | | | | | |
| ETV 7.5 - 100 | 7.5 | | | | 14.7 | 14.3 | 14 | 13.4 | 12.6 | 11.3 | 6.7 | | | | | | | | | | | | | | | |
| ETV 9 - 100 | 9 | | | | 16.1 | 15.7 | 15.4 | 14.9 | 14.1 | 12.7 | 8.7 | | | | | | | | | | | | | | | |
| ETV 11 - 150 | 11 | | | | 15.2 | 14.7 | 14.4 | 14 | 13.7 | 13.3 | 12.3 | 11.1 | 9.4 | 7.1 | 4.2 | | | | | | | | | | | |
| ETV 15 - 150 | 15 | | | | 18.6 | 18.1 | 17.8 | 17.4 | 17 | 19.4 | 15.6 | 14.2 | 12.8 | 10.8 | 8 | 4.8 | | | | | | | | | | |
| ETV 18.5 - 150 | 18.5 | 21.5 | 20.9 | 20.7 | 20.2 | 19.9 | 16.7 | 18.5 | 17.1 | 15.7 | 13.7 | 11 | 8 | | | | | | | | | | | | | |

- DIAGRAMMI -

- PERFORMANCES RANGES -

- CURBES CARACTERISTIQUES -

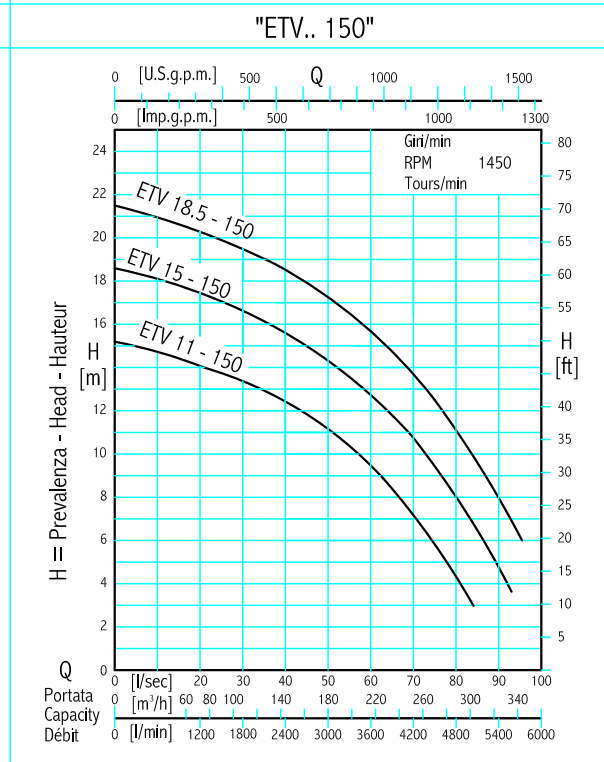
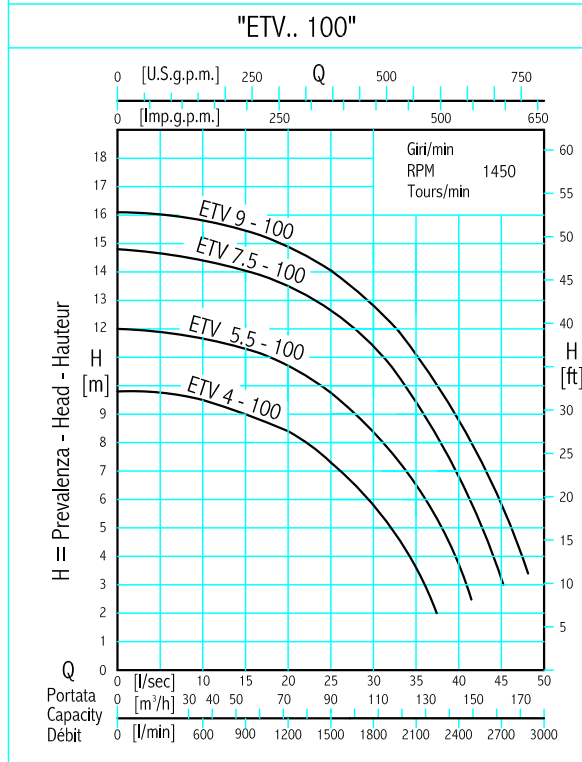
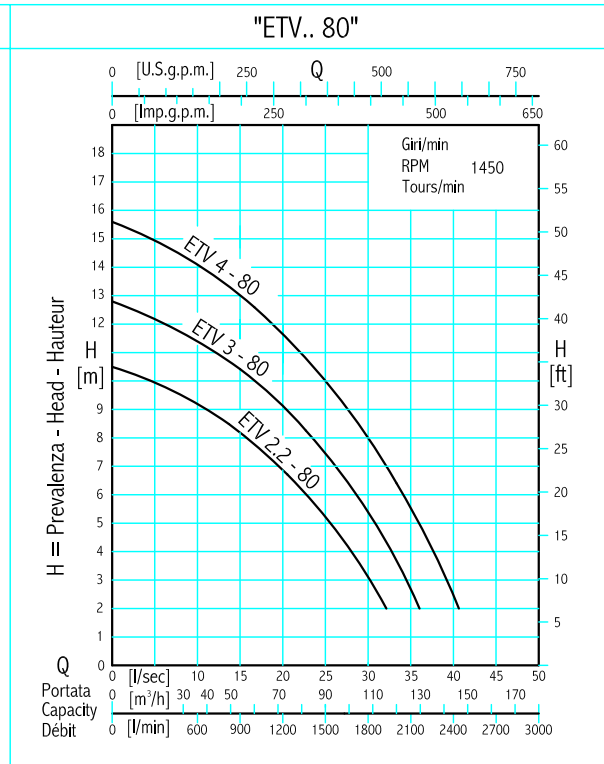
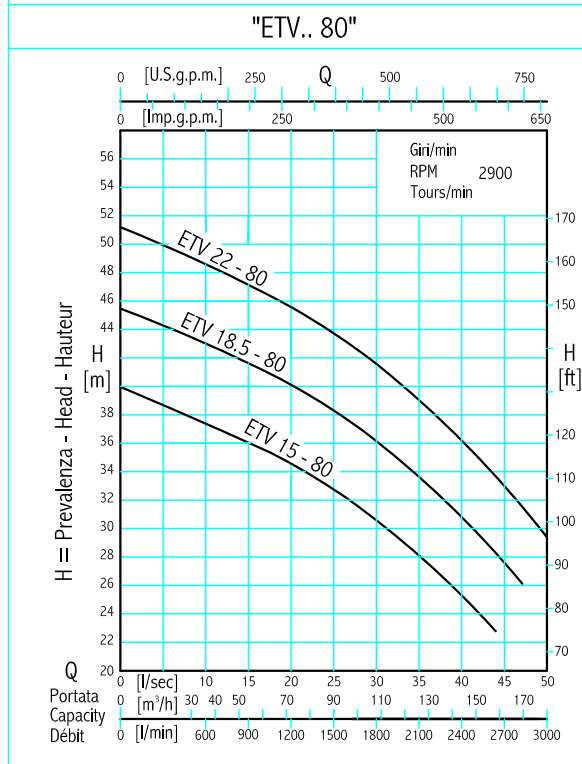

Curve per liquidi aventi densità 1-viscosità 1 mm²/s - alla temperatura di 20°C.
 Curves established for liquid density 1- viscosity 1 mm²/s- temperature 20° C.
 Curbes établies pour liquides densité 1- viscosité 1 mm²/s - température 20° C.

Flangia UNI-PN6
Flange UNI-PN6
Bride UNI-PN6

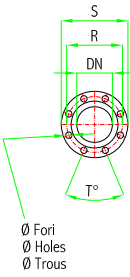

| Flange | Flanges | | | Brides | |
|--------|---------|-----|-----|------------------|--------|
| DN | R | S | T° | \emptyset Fori | n°Fori |
| 80 | 150 | 190 | 90° | 18 | 4 |
| 100 | 170 | 210 | 90° | 18 | 4 |
| 150 | 225 | 265 | 45° | 18 | 8 |
| 200 | 280 | 320 | 45° | 18 | 8 |

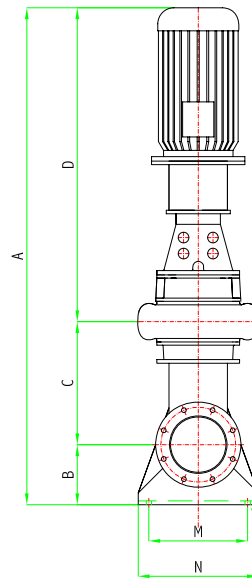
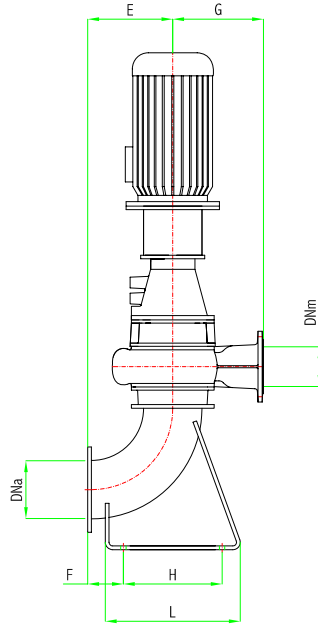

Orientamento Mandata
Delivery Orientation
Orientation orificie de refoulement

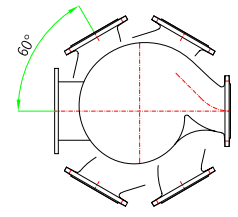

N°4 Fori \emptyset P
N°4 Holes \emptyset P
N°4 Trous \emptyset P

| POMPA TIPO PUMP TYPE POMPE TYPE | Potenza motore Motor rating Puissance moteur [kW] | Giri/min RPM T/min | Aspirazione Suction Orifice aspiration DNa | Mandata Delivery Refoulement DNm | DIMENSIONI INGOMBRO OVERALL DIMENSIONS [mm] DIMENSIONS | | | | | | | | | | | | |
|---------------------------------------|--|--------------------------|---|---|--|-----|------|------|-----|------|-----|-----|-----|-----|------|-----|-----|
| | | | | | A | B | C | D | E | F | G | H | L | M | N | P | |
| | | | | | ETV 15 - 80 | 15 | 2900 | 100 | 80 | 1452 | 150 | 338 | 964 | 166 | 63.5 | 239 | 205 |
| ETV 18.5 - 80 | 18.5 | 1496 | 1008 | | | | | | | | | | | | | | |
| ETV 22 - 80 | 22 | 1219 | 731 | | | | | | | | | | | | | | |
| ETV 2.2 - 80 | 2.2 | 1237 | 749 | | | | | | | | | | | | | | |
| ETV 3 - 80 | 3 | 1291 | 781 | | | | | | | | | | | | | | |
| ETV 4 - 80 | 4 | 1327 | 817 | | | | | | | | | | | | | | |
| ETV 4 - 100 | 4 | 1450 | 150 | 100 | 1291 | 170 | 340 | 781 | 243 | 98 | 263 | 290 | 398 | 290 | 350 | 18 | |
| ETV 5.5 - 100 | 5.5 | | | | 1327 | | | 817 | | | | | | | | | |
| ETV 7.5 - 100 | 7.5 | | | | 1385 | | | 875 | | | | | | | | | |
| ETV 9 - 100 | 9 | | | | 1773 | | | 1092 | | | | | | | | | |
| ETV 11 - 150 | 11 | 200 | 150 | 150 | 1773 | 225 | 456 | 1092 | 317 | 134 | 340 | 370 | 506 | 370 | 450 | 20 | |
| ETV 15 - 150 | 15 | | | | 1817 | | | 1136 | | | | | | | | | |
| ETV 18.5 - 150 | 18.5 | | | | 1843 | | | 1162 | | | | | | | | | |

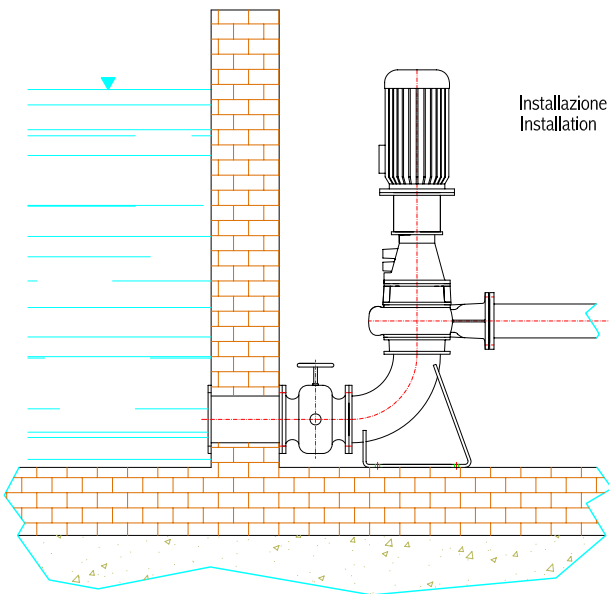

| ACCESSORI | ACCESSORIES | ACCESSOIRES |
|---------------------------------------|---|-------------|
| | | |
| POMPA TIPO PUMP TYPE POMPE TYPE | Saracinesca Flangiata Flanged gate Vanne bridée | |
| ETO ... - 80 | DN 100 - PN 6 | |
| ETO ... - 100 | DN 150 - PN 6 | |
| ETO ... - 150 | DN 200 - PN 6 | |